

START

1

Resistor - Weerstand - Résistance -
Widerstand - Resistencia - Motstand -
Vastus - Resistenze

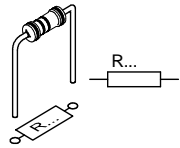

Lower side - Componentzijde
- Inférieur soie - Niedriger seide
- Inferior seda

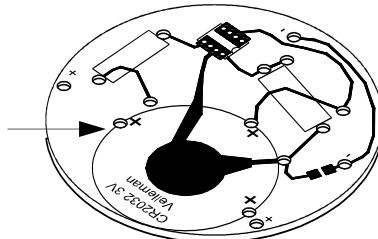

◇ R1 : 100

(Brown, Black, Brown) -(Bruin, zwart, Brown) -(Brun, noir, Brun) -(Braun, Schwarz, Braun) -(Brun, Svart, Brun) -(Ruskea, Musta, Ruskea) -(Marrón, Negro, Marrón) -(Castanho, Preto, Castanho) -(Marrone, Nero, Marrone)

◇ R2 : 100K

(Brown, Black, Yellow) -(Bruin, zwart, Geel) -(Brun, noir, Jaune) -(Braun, Schwarz, Gelb) -(Brun, Svart, Gul) -(Ruskea, Musta, Keltainen) -(Marrón, Negro, Amarillo) -(Castanho, Preto, Amarelo) -(Marrone, Nero, Giallo)

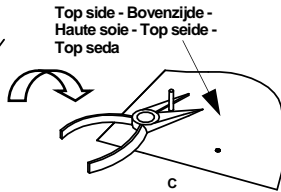
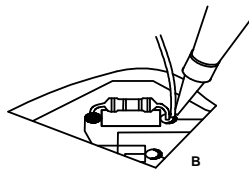
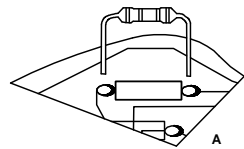

Top side - Bovenzijde -
Haute soie - Top seide -
Top seda

2

BATTERY HOLDER

solder drop - soldeer
druppel - goutte de soudure
- Lot Tropfen -
gota de soldadura

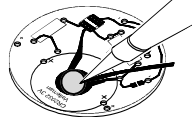
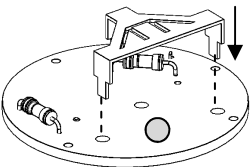

C

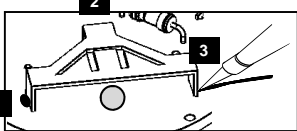

3

IC

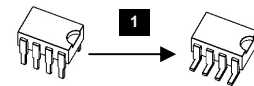

Watch the notch !
Attention à l'encoche !

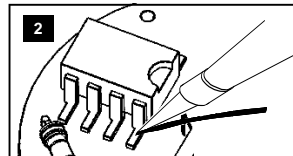
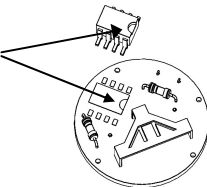

◇ IC1 : VMK167 (programmed PIC10F200-I/PG)

4

PCB TABS

◇ 4 x

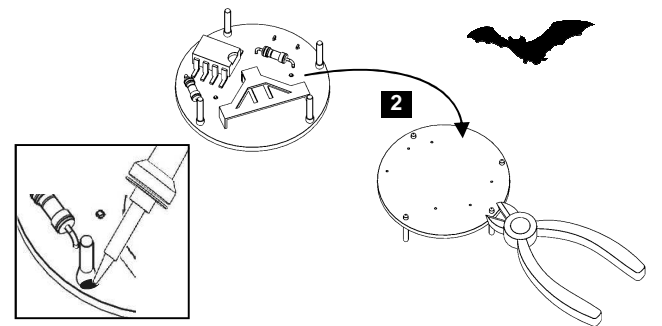
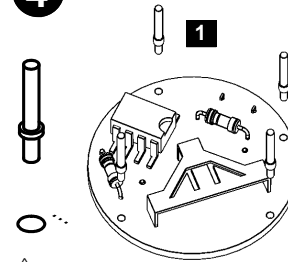

5

BUTTON

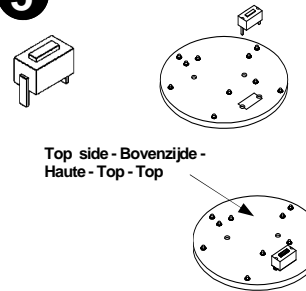

Top side - Bovenzijde -
Haute - Top - Top

6

LED

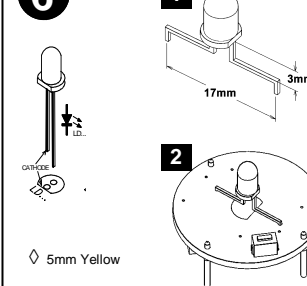

◇ 5mm Yellow

7

LED COVER

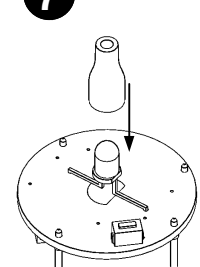

8

BATTERY

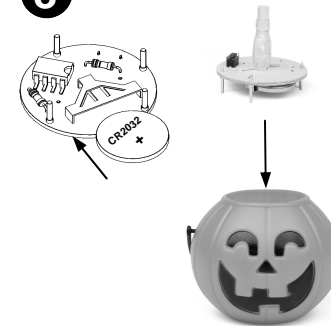

9

OPERATION



realistically flickering flame - realistisch
flakkerende vlam - flamme vacillante -
teelicht (Flamme) flimmert realistisch -
flama oscilante

fade in - fade out - ouverture/fermeture
en fondu - encendido/apagado lento
(fade in/out)

steady flame - stabiele vlam - flamme
stable - teelicht (Flamme) brandt
gleichmäßig - flama fija

deactivated - uitgeschakeld - désactivé
- ausgeschaltet - desactivado

DIAGRAM

